



MULTICAL® 403





MULTICAL® 403



> 60 °C













230 VAC



16/25 bar



	04
	05
	07
	12
	19
	22
	24
	27
	28
	31



https://guides.kamstrup.com/userguides/gb_mc403.htm



<https://www.kamstrup.com/en-en/heat-solutions/meters-devices/meters/multical-403/documents>



<https://www.kamstrup.com/>



1/2

E1

MID ✓ EN 1434 ✓

θ : 2 °C...180 °C $\Delta\theta$: 3K...178K ✓

E3

DK-BEK 1178 ✓ EN 1434 ✓

θ : 2 °C...180 °C $\Delta\theta$: 3K...178K ✓

E2

θ_q : 2°C...130°C ✓



E1 ✓ **E2** ✓

M1 ✓ **M2** ✓

5°C...55°C ✓

IP 54 ✓

IP 68 ✓

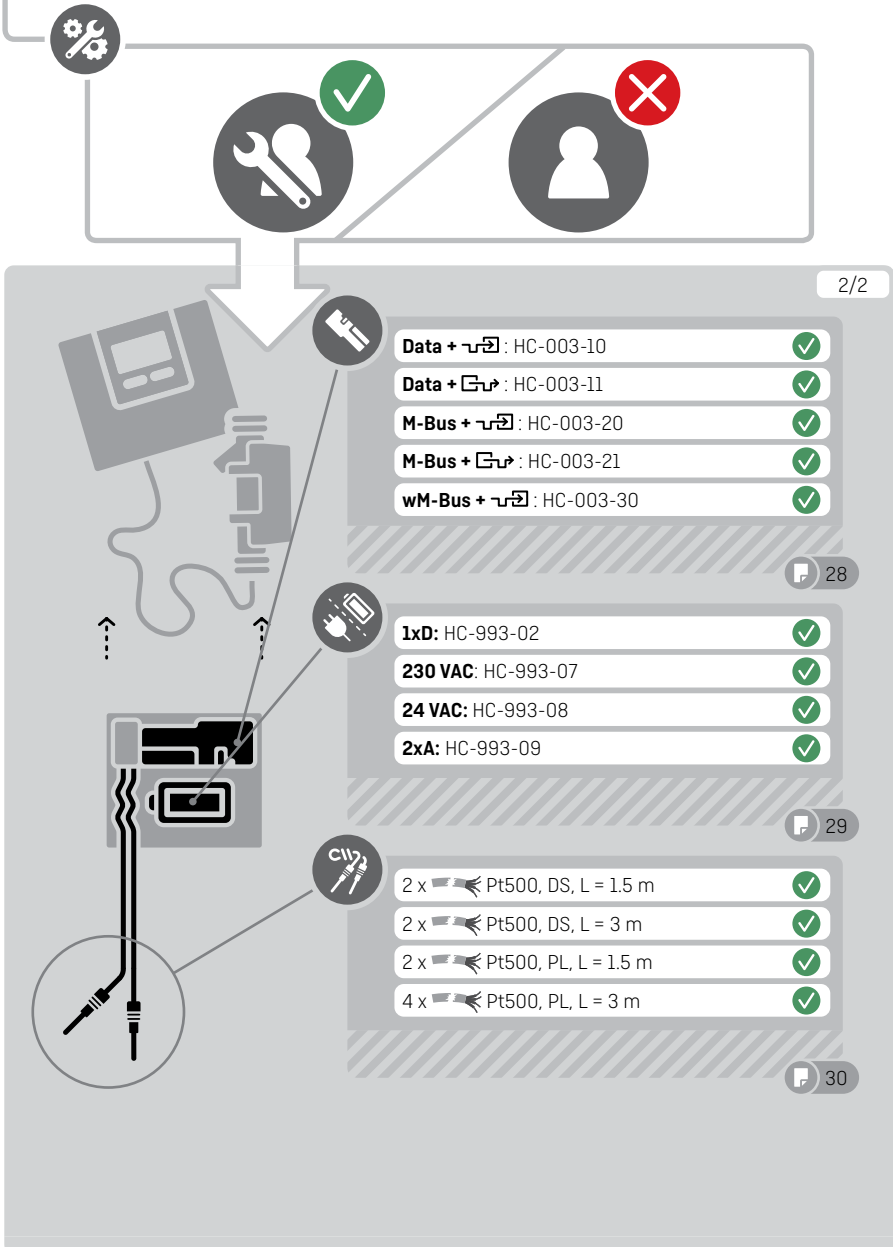

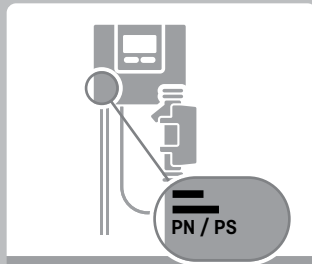

- PN16, PS16 ✓
- PN25, PS25 ✓
- PN16/PN25, PS25 ✓

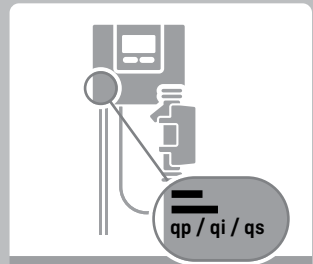

- qp: XX m³/h ✓
- qi: XX l/h ✓
- qs: XX m³/h ✓

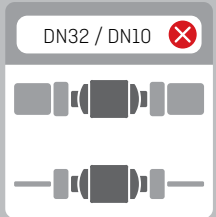
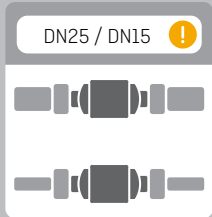
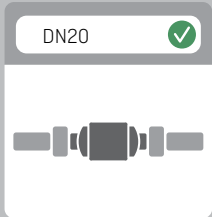
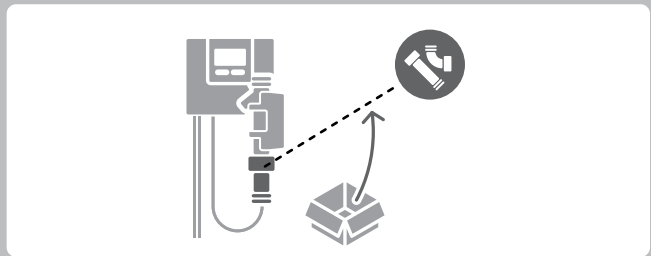

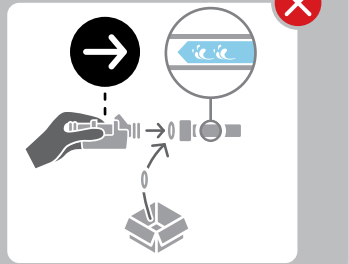
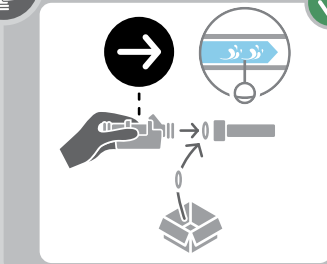
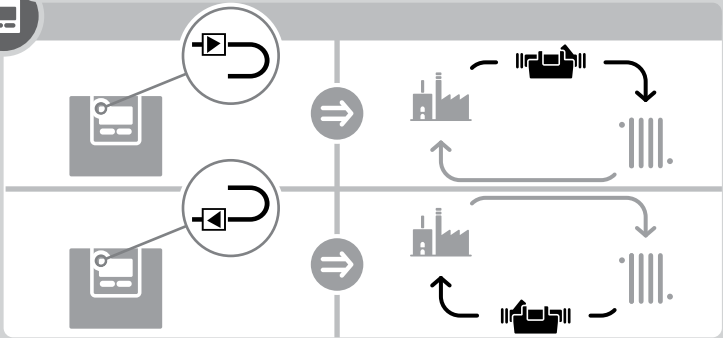
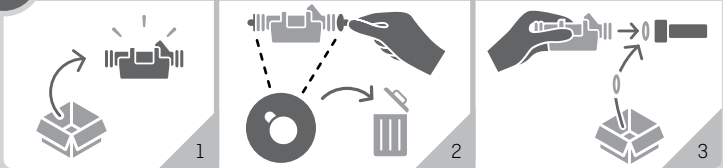

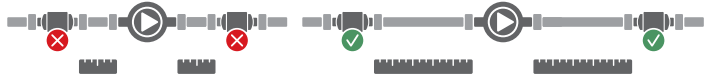

47

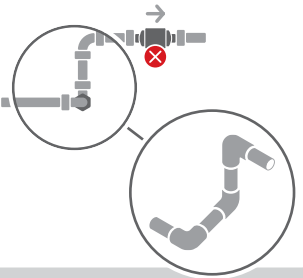
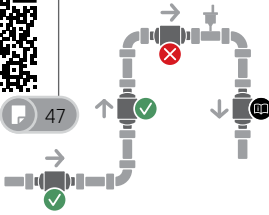

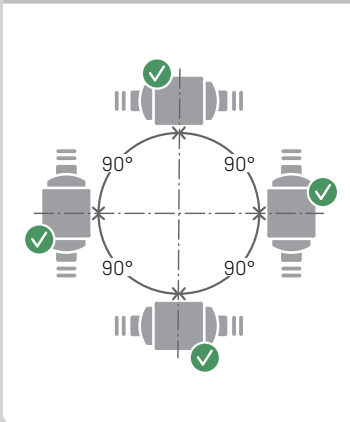

qp 0.6...2.5 m³/h



qp ≥ 3.5 m³/h

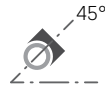

qp ≥ 6.0 m³/h

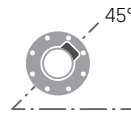



qp 0.6...2.5 m³/h



49

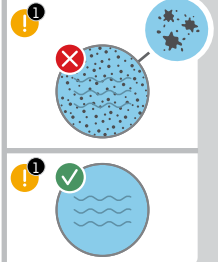
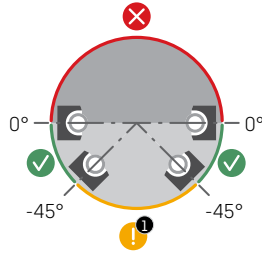

qp ≥ 3.5 m³/h



qp ≥ 6.0 m³/h

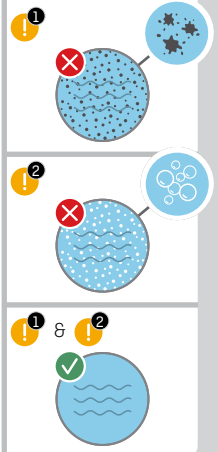
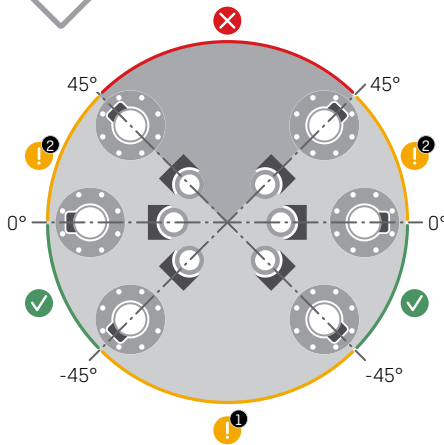

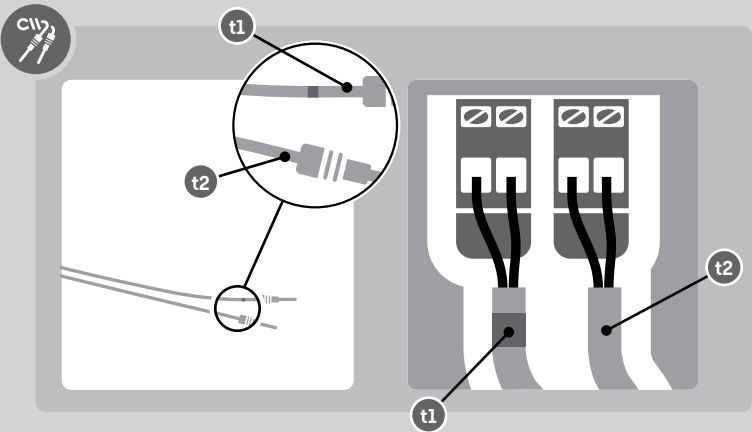
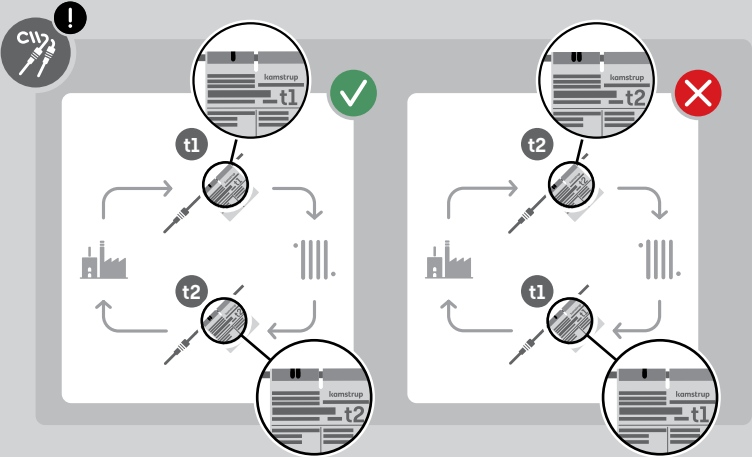



[x1] t1

[x2] t2

[x0] t3

	t1	t2	t3

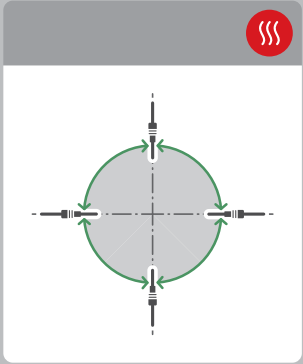
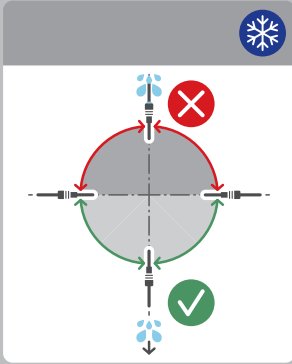
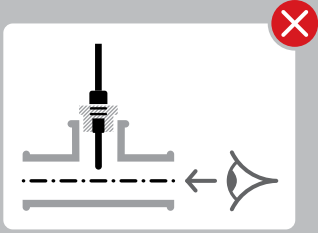
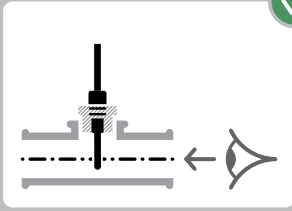



PN16 PN25

PN16 PN25



qp	DN	G
0.6-1.5	15	G¾B
0.6-1.5	20	G1B
3.5-6	25	G5/4B
10	40	G2B
15	50	-



+

DS 27.5
X
X
X

+

DS 38
X

+

PL Ø5.8
X

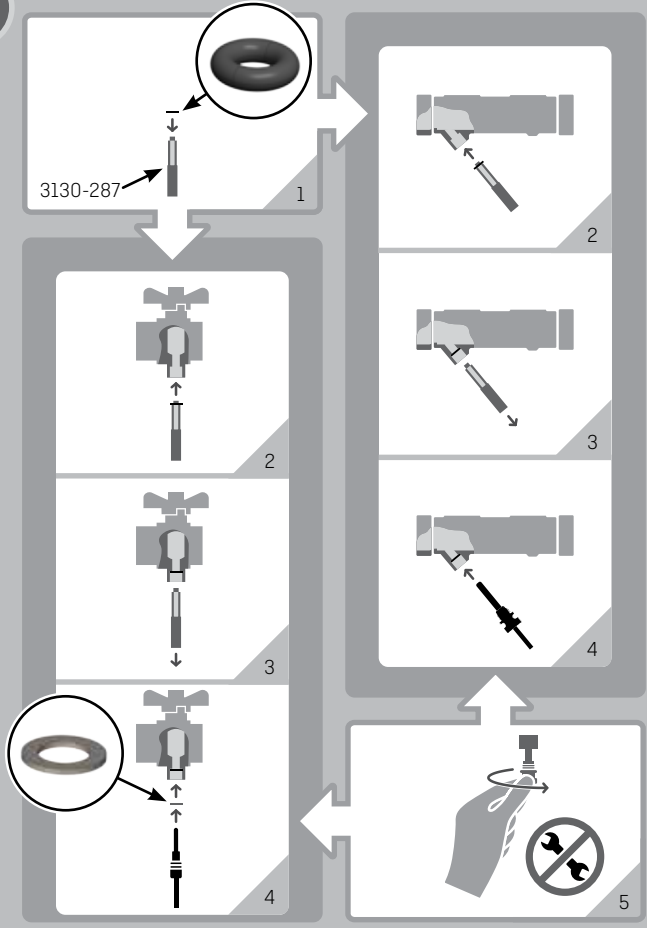

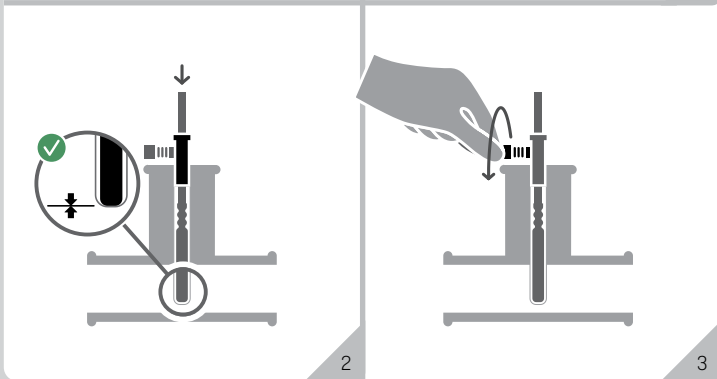
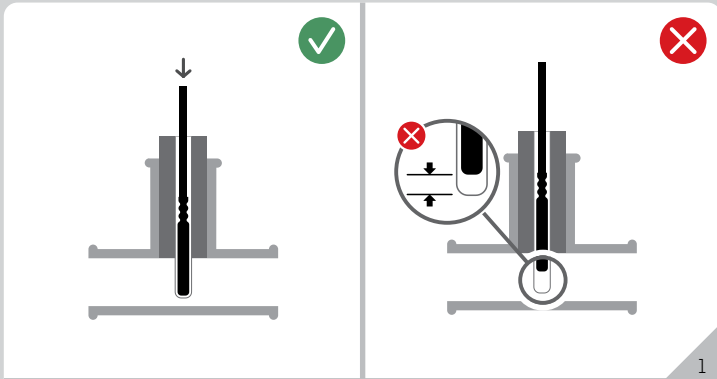
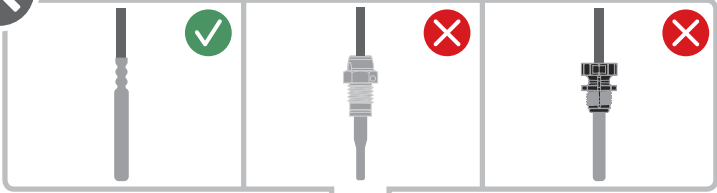



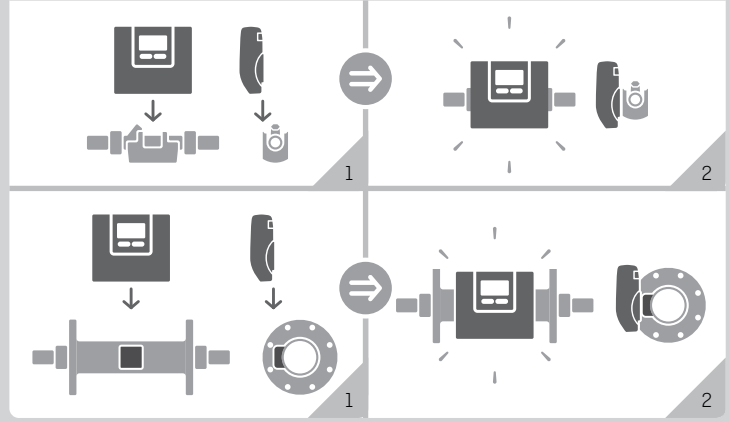

$q_p \leq 2.5 \text{ m}^3/\text{h}$ ✓ $\theta_q > 90 \text{ }^\circ\text{C}$ ✓ $\theta_q < \text{RT}$ ✓

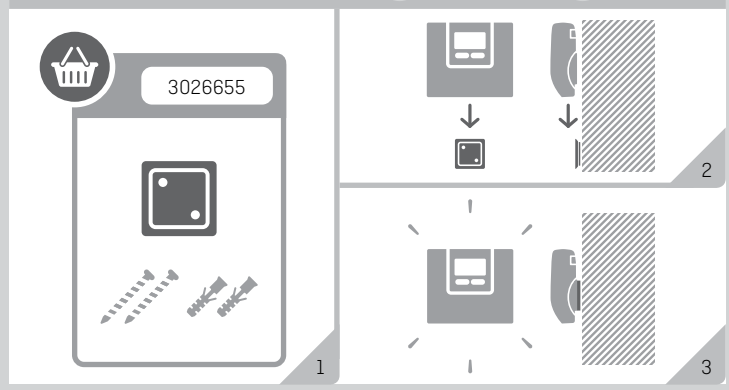



$q_p > 2.5 \text{ m}^3/\text{h}$ ✓

$\theta_q > 90 \text{ }^\circ\text{C}$ ✓

$\theta_q < \text{RT}$ ✓

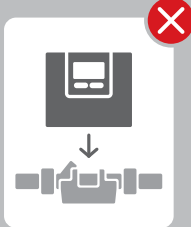
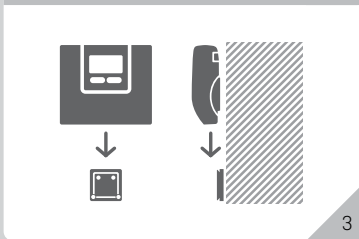
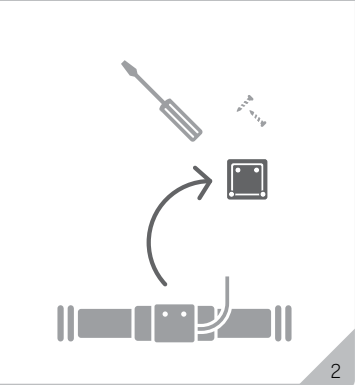
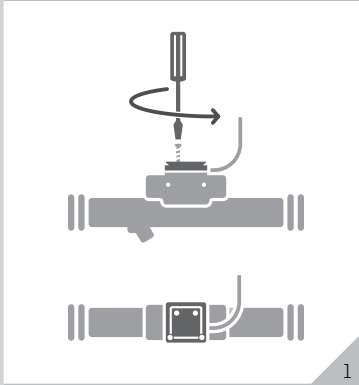

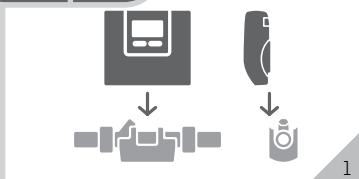

1

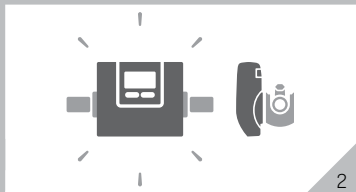

2

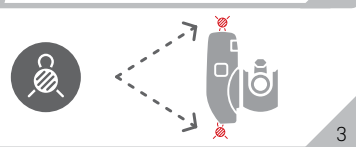
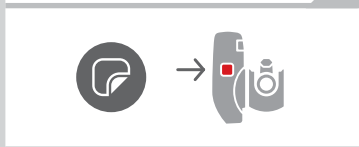

3

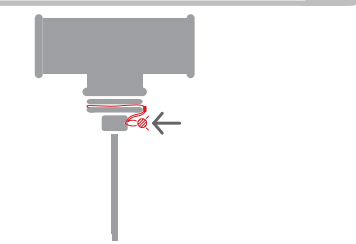
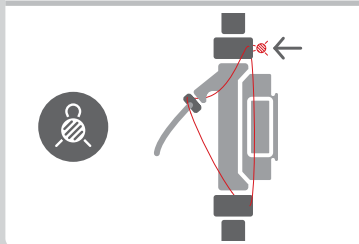

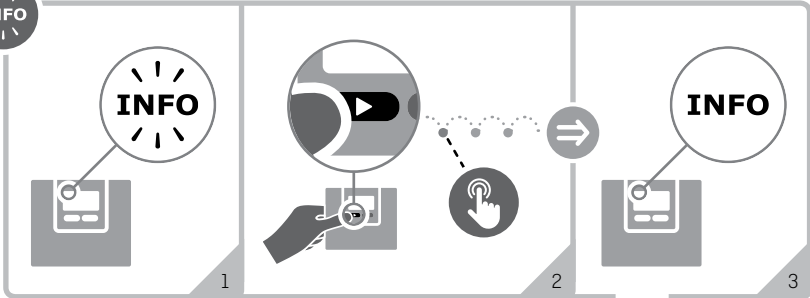

1/2

	1	2	3	4	5	6	7	8	
Info	t1	t2	0	V1	0	In-A	In-B		
1									
2									
9									
	1								t1 > 185 °C
		1							t2 > 185 °C



INFO

Info	t1	t2	0	V1	0	In-A	In-B
	2						
		2					
	9	9					
				3			
				4			
				6			
						8	
						9	
						8	
						9	

$t1 < 0\text{ }^{\circ}\text{C}$

$t2 < 0\text{ }^{\circ}\text{C}$

$\Delta t (t1 - t2) = \text{X}$

V1:

V1:

$V1 > q_s$

A:

A:

B:

B:

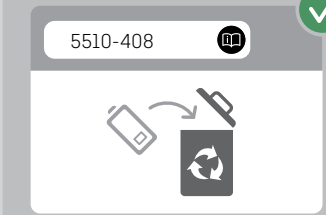
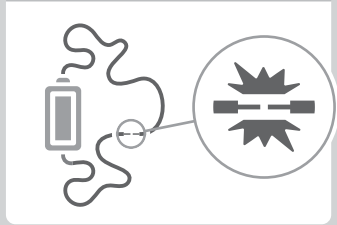
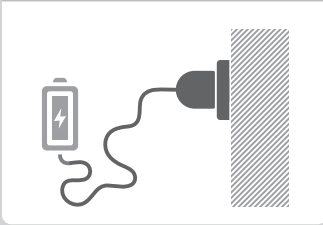



230 VAC / 50 Hz / 1 W



230 VAC / 50 Hz / 1 W

24 VAC / 50 Hz / 1 W



24 VAC / 50 Hz / 1 W

230 VAC

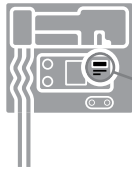

230 VAC

24 VAC

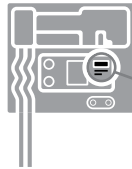

24 VAC



d = 5...8 mm

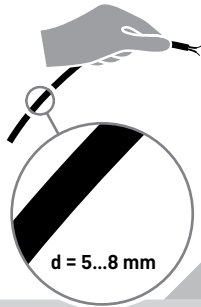

1

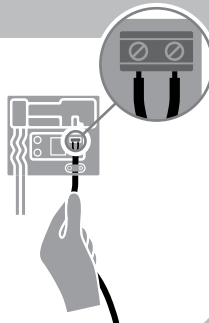

2

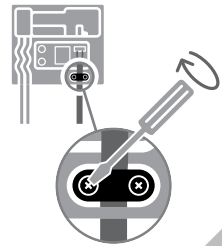

3

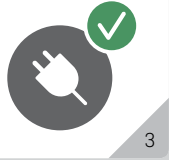
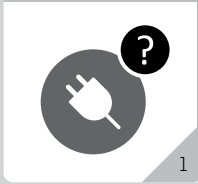

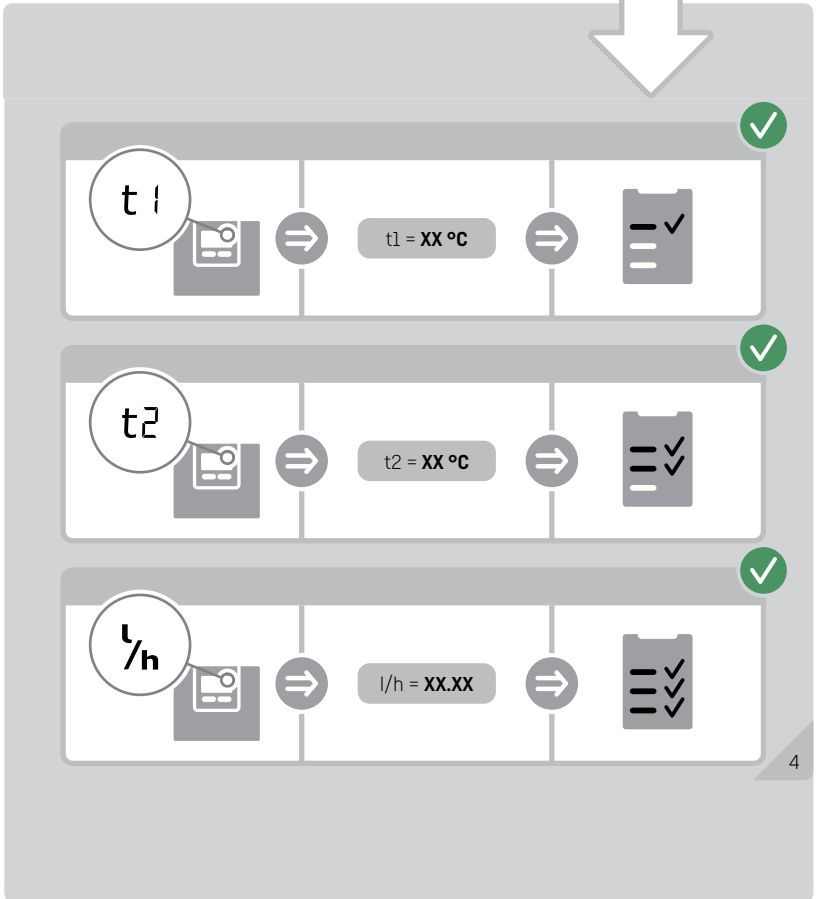
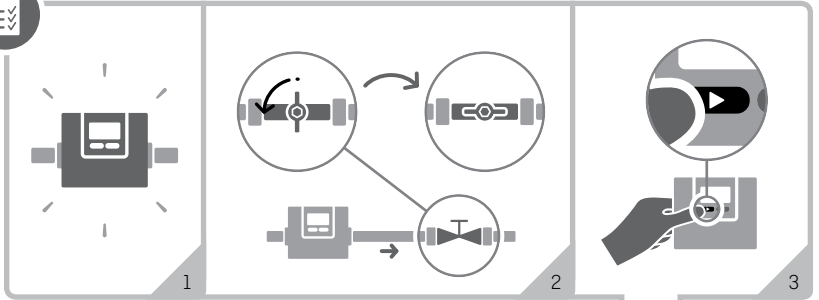



<https://www.kamstrup.com/en-en/heat-solutions/meters-devices/meters/multical-403> ✓



Data +	HC-003-10	✓
Data +	HC-003-11	✓
M-Bus +	HC-003-20	✓
M-Bus +	HC-003-21	✓
M-Bus +	HC-003-22	✓
linkIQ/wM-Bus +	HC-003-32	✓
linkIQ/wM-Bus +	HC-003-33	✓
wM-Bus+	HC-003-34	✓
Analog	HC-003-40	✓
PQT+	HC-003-43	✓
Radio +	HC-003-50	✓
Radio GDPR +	HC-003-51	✓
NB-IoT +	HC-003-56	✓
BACnet +	HC-003-66	✓
Modbus RTU +	HC-003-67	✓
BACnet IP +	HC-003-81	✓
Modbus +	HC-003-82	✓

= In-A / In-B

= Out-C / Out-D

= Out 1 / Out 2



<https://www.kamstrup.com/en-en/heat-solutions/meters-devices/accessories>

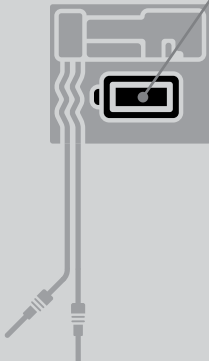
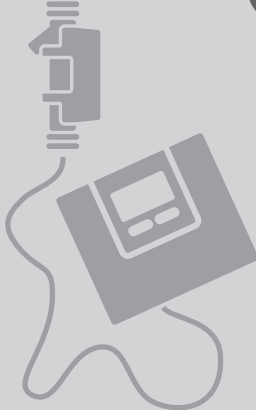

1xD	HC-993-02	✓
230 VAC ⚡	HC-993-03	✓
24 VAC/VDC ⚡	HC-993-04	✓
1xC IoT	HC-993-06	✓
230 VAC	HC-993-07	✓
24 VAC	HC-993-08	✓
2xA	HC-993-09	✓



<https://www.kamstrup.com/en-en/heat-solutions/meters-devices/temperature-sensors>

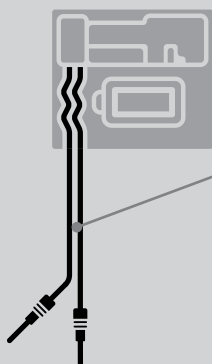

- 2 x Pt500, DS, L = 1.5 m
- 2 x Pt500, DS, L = 3 m
- 2 x Pt500, PL, L = 1.5 m
- 4 x Pt500, PL, L = 3 m



The diagram illustrates the layout of the device's display, which is divided into several sections:

- Top Row:**
 - Left: VOL A, 0034732 m², icon A.
 - Middle: 15.7 kW, icon kW.
 - Right: 0.343 l/h, icon l/h.
- Left Column (from top to bottom):**
 - EL b, 0014958 kWh, icon B.
 - TA 2, 0009089 MWh, icon TA2.
 - TA 3, 0005453 MWh, icon TA3.
 - TA 4, 0003635 MWh, icon TA4.
 - INFO, 00000000, icon !.
- Right Column (from top to bottom):**
 - t 12, 39.38 °C, icon t1, t2.
 - t 2, 27.14 °C, icon t2, home.
 - t 1, 66.52 °C, icon t1, home.
 - h, 0026280 h, icon h.
 - VOL, 0102906 m³, icon m³.
- Bottom Row:**
 - N°, 123, icon 1.
 - E 1, 0046092 MWh, icon E1.
 - E 3, 0039350 MWh, icon E3.



DDD = 310/610

https://guides.kamstrup.com/userguides/gb_mc403.htm



MULTICAL® 403

